



SIEMENS PS2

MOUNTING INSTRUCTIONS sliding stem and rotary applications





MOUNTING INSTRUCTIONS

For linear valves, mount all hardware as shown in *Figure 1*.

To determine which holes on the *mounting bracket* to use, follow these steps:

- 1 Set the actuator at half travel.
- 2 Align the *feedback loop* (Key 5) and *feedback arm* (Key 4) so that they are both horizontal, as shown in *Figure 1*.
- 3 The *feedback loop* (Key 5) should be compressing the spring on the *feedback arm assembly* (Key 4) anywhere between 1/4" and 1/2".
- 4 Depending on the actuator type, size, and travel, a different combination of holes on the mounting bracket will have to be used for each application. The top 5 rows of holes are used to mount to the actuator. The bottom 4 rows are used to mount to the positioner. Choose the combination that best allows the *feedback arm* (Key 4), and the *feedback loop* (Key 5) to be horizontal and parallel at half travel.
- 5 Once this arrangement is set, tighten all the fasteners.
- 6 Follow start-up as described in this handbook or in Chapter 9 of the Siemens SIPART PS2 Operating Instructions Edition 09/2014.

MOUNTING INSTRUCTIONS

Figure 1 Hardware Mounting Diagram

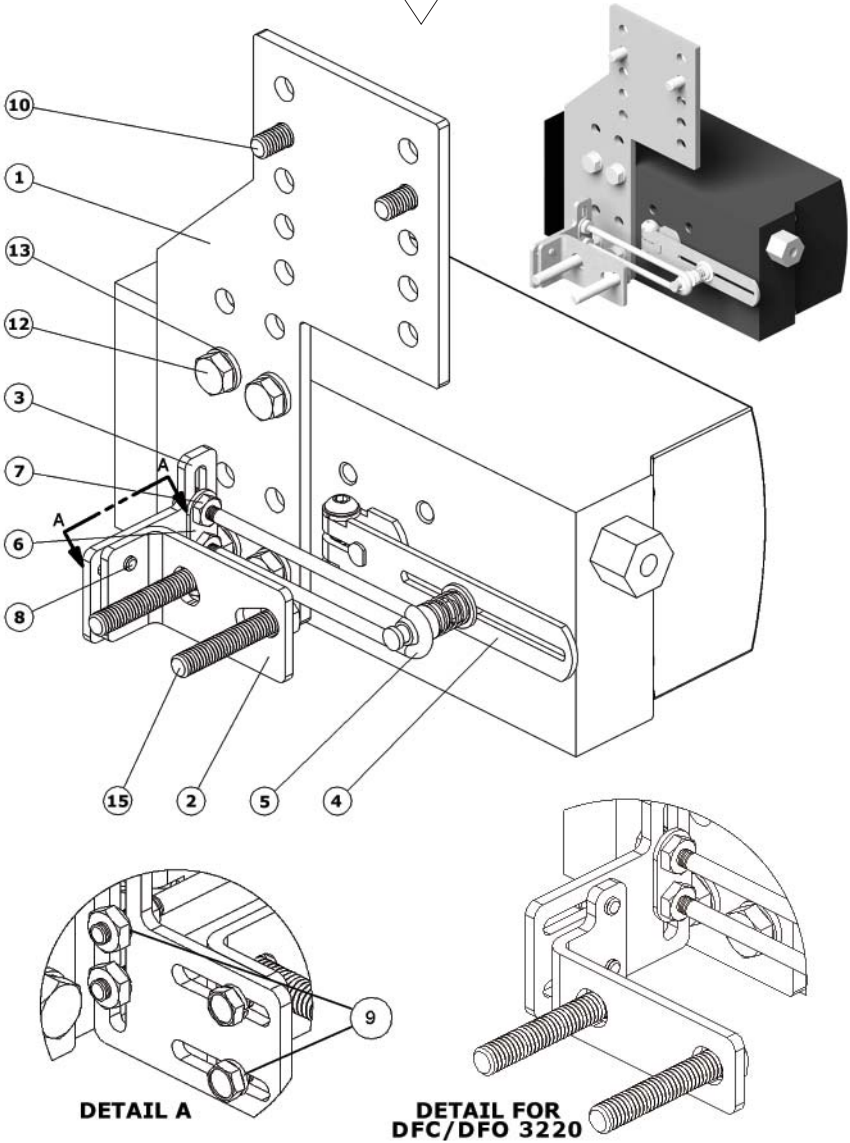

**MOUNTING INSTRUCTIONS****Linear Actuator Mounting Parts List**

Key	Quantity	Description
1	1	Bracket, Yoke - Sliding Stem
2	1	Mounting Bracket - Connecting Block
3	1	Adjusting Bracket - Feedback Loop
4	1	Feedback Arm Assembly
5	1	Feedback Loop
6	1	Washer - Feedback Loop
7	4	Hex Nut
8	2	Hex Cap Screw, Adjusting Bracket - Mounting
9	4	Lock-washer
10	2	Hex Cap Screw, Mounting Bracket - Positioner
11	2	Lock-washer, Mounting Bracket - Yoke (Not Shown)
12	4	Hex Cap Screw, Mounting Bracket - Positioner
13	4	Lock-washer, Mounting Bracket - Positioner
14	2	Airset Mounting Screw (Not Shown)
15	2	Hex Cap Screw - Connecting Block (Not Included - Use Existing Cap Screws)
16	1	Airset Regulator (Not Shown)
17	2	Spacer, Mounting Bracket - Yoke (Not Shown - Sizes 1046, 1069, & 2069 Only)

*For Mounting Instructions See Page 2, For Diagrams See Page 3.

Basic Rotary Actuator Mounting Parts List

Key	Quantity	Description
1	1	Mounting Bracket - Rotary
2 & (2A)	4	Lock-washer (Large Lock-washer)
3	4	Hex Cap Screw
4	1	Coupler
5	1	Travel Indicator
6	1	Pin Assembly
9	2	Hex Cap Mounting Bolt
10	2	Lock-washer
11	2	Spacer

*For Mounting Instructions See Page 7, For Diagrams See Page 5 - 7.

Basic Quarter Turn Rotary Actuator Mounting Parts List

Key	Description	Key	Description
1	Coupling Wheel	6	Hex Cap Screw
2	Carrier	7	Lock-washer
3A	Scale	8	Fillister Head Screw
3B	Indicator Sticker	9	Washer
4	Mounting Bracket	10	Hex Socket Cap Screw

*For Mounting Instructions See Page 9, For Diagrams See Page 8.

MOUNTING INSTRUCTIONS

Figure 2
Basic Rotary
Mounting Diagram
DFR026 / DFR047

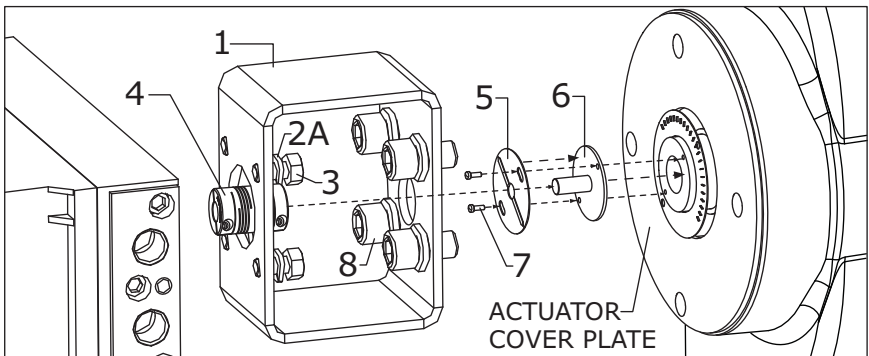
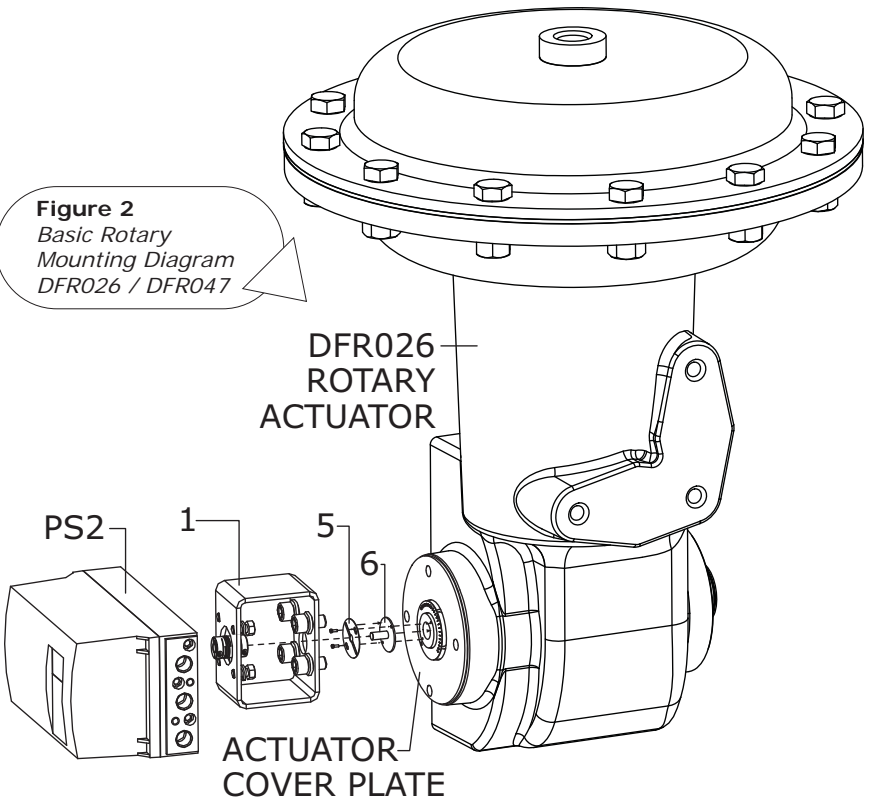



MOUNTING INSTRUCTIONS

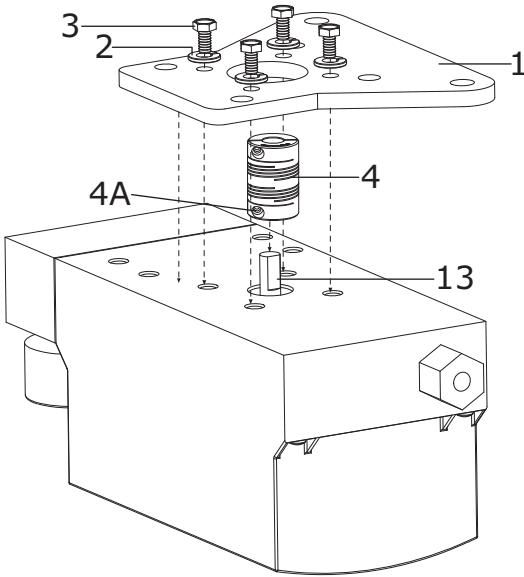

Figure 2A
Basic Rotary
Mounting Diagram
DFR070 - DFR220

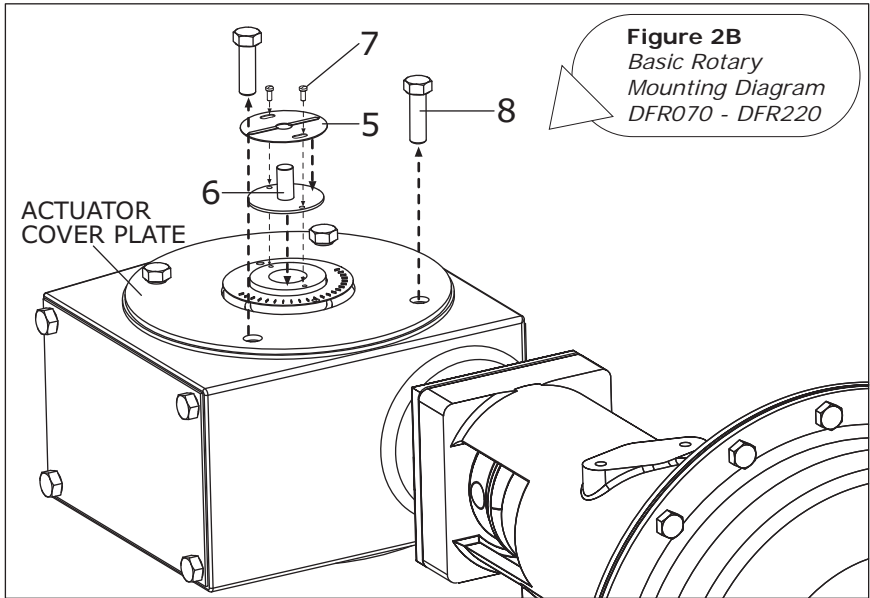
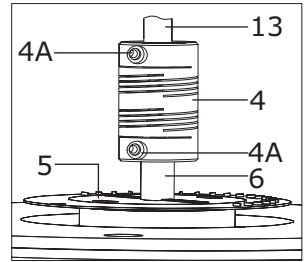
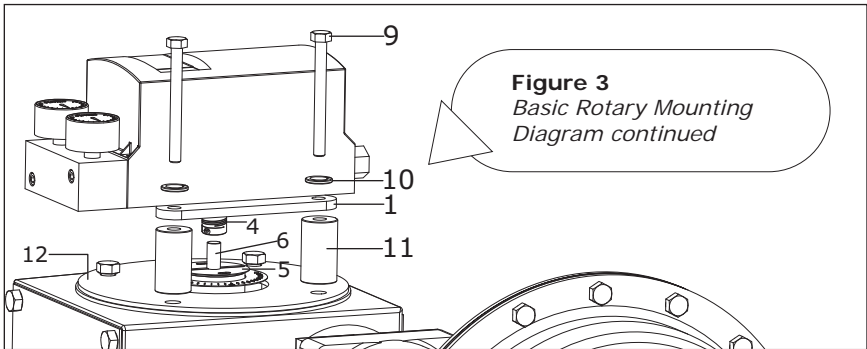

Figure 2B
Basic Rotary
Mounting Diagram
DFR070 - DFR220

MOUNTING INSTRUCTIONS

Mount all hardware as shown in *Figures 2 - 3*. Mounting Parts List on Page 4.
To mount a Siemens PS2 to a Rotary Actuator, follow these steps:

- 1 Remove the two *hex cap screws* (Key 8) from the *actuator cover plate* (Key 12). Remove the *travel indicator screws* (Key 8) and *travel indicator* (Key 5). (Do not discard these parts)
- 2 Place the *travel indicator* over the pin of the *pin assembly* (Key 6) and place them both onto the *actuator hub*. Align all the screw holes and thread in the *travel indicator screws*; completely tighten the *travel indicator* and *pin assembly* to the *actuator hub*.
- 3 Align the *mounting bracket* (Key 1) perpendicular to the back of the *Siemens positioner* so that the four screw holes match the holes on the positioner (See Figure 2A). Install the *lock-washers* (Key 2) and *cap screws* (Key 3) and completely tighten the *bracket* to the *positioner*.
- 4 Slide the *coupler* (Key 4) onto the *input shaft* (Key 13) of the *positioner*. Completely tighten the *coupler screw* (Key 4A) using the appropriate hex key.
- 5 Place the *spacers* (Key 11) over the holes on the *actuator cover plate*. Place the *PS2/mounting bracket assembly* onto the *actuator* being careful to have the *coupler* fit over the *pin assembly* (See Figure 3). Slide the two *lock-washers* (Key 10) onto the *mounting cap screws* (Key 9). Thread the *cap screws* through the *bracket* (Key 1) and *spacers* (Key 11) and into the *actuator cover plate* holes. Completely tighten the *cap screws* and then completely tighten the 2nd *coupler screw* (Key 4A) securing it to the *pin assembly*.
- 6 Follow Start-up as described in this handbook or in chapter 9 of the Siemens SIPART PS2 Operation Instructions Edition 09/2014.



Siemens PS2 MOUNTING INSTRUCTIONS

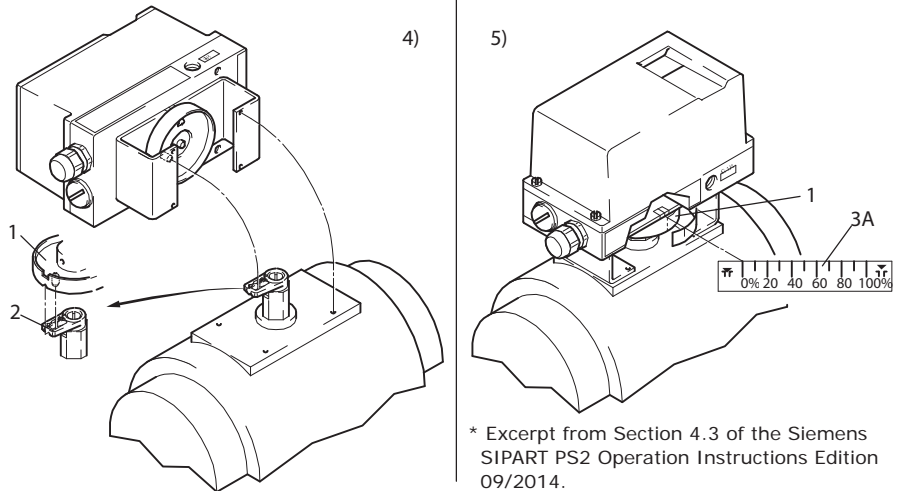
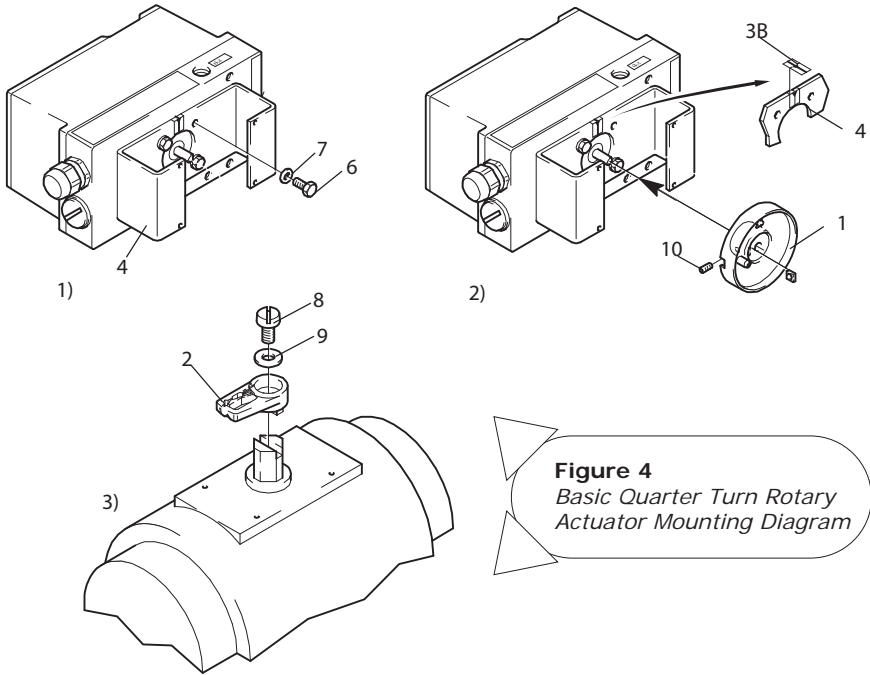

Siemens PS2 Installation Guide P-PS2I0116B

**MOUNTING INSTRUCTIONS**

Mount all hardware as shown in *Figure 4*. Quarter Turn Actuator Mounting Parts List on Page 5. To mount a Siemens PS2 to an Quarter Turn Actuator, follow these steps:

- 1 Adhere *indicator sticker* (Key 3B) onto the *mounting bracket* (Key 4) in the center of the centering hole (See Figure 4.2).
- 2 Attach the *mounting bracket* (Key 4) (actuator specific) onto the rear of the *positioner* and secure using *lock-washers* (Key 7) and *hex cap screws* (Key 6).
- 3 Push the *coupling wheel* (Key 1) onto the *input shaft*, pull it back by about 1 mm and tighten the *hex socket cap screw* (Key 18) with the appropriate hex key.
- 4 Place the *carrier* (Key 2) onto the end of the *actuator* and secure it using a *washer* (Key 9) and *Fillister head screw* (Key 8).
- 5 Carefully place the positioner with the *mounting bracket* onto the *actuator* such that the pin of the *coupling wheel* engages in the driver.
- 6 Align the *positioner/mounting bracket assembly* in the center of the *actuator* and screw tight. (Screws may not be included in delivery; they are part of the actuator mounting console)
- 7 Following the Start-up instructions as described in Chapter 9 of the SIPART PS2 Operation Instructions Edition 09/2014: Drive the actuator to the end position and adhere *scale* (Key 3A) on the *coupling wheel* (Key 1) according to direction of rotation and rotary actuator.

SIEMENS PS2

Dyna-Flo Control Valve Services LTD Edmonton, AB

1911 - 66 Avenue
Edmonton, Alberta, Canada
T6P 1M5

www.dynaflo.com

Phone: (780) 469-4000

General Fax: (780) 469-3149

Sales Fax: (780) 469-4035

Toll Free: 1-866-396-2356

Dyna-Flo Control Valve Services LTD Calgary, AB

#300, 404 - 6th Avenue SW,
Calgary, Alberta, Canada
T2P 0R9

Phone: (403) 861-5935

General Fax: (403) 269-2287

Toll Free: 1-866-396-2356

www.dynaflo.com

Dyna-Flo Control Valve Services LTD Pasadena, TX

2003C Preston Avenue
Pasadena, Texas, U.S.A.
77503

Phone: (713) 477-7466

General Fax: (713) 477-7467

Toll Free: 1-866-396-2356

www.dynaflo.com